

BS-S-4,8

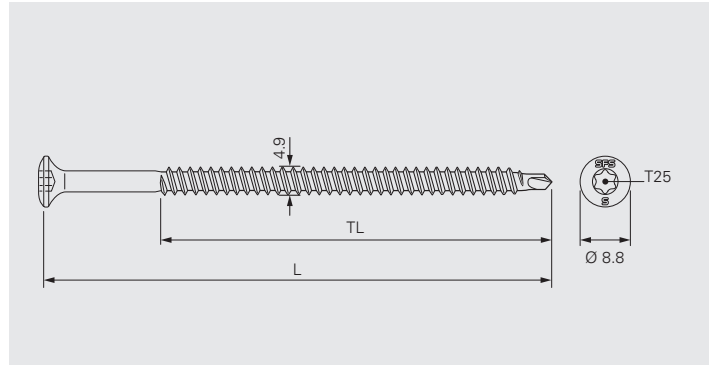

Application 1

Stainless steel fastener for waterproof membrane and insulation securement on steel deck. For applications with increased requirements, such as high relative humidity, chemical aggressive atmospheres or conditions (e.g. coastal environments). For refurbishments with unknown condition of the existing build-up or build-up with abrasive layers that may damage the corrosion protection. If extended design life and/or warranty is required.

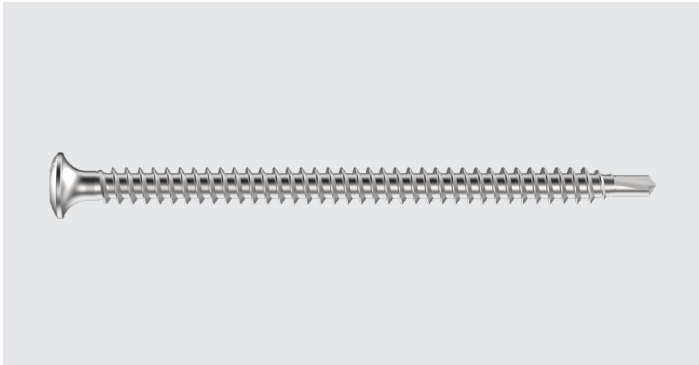
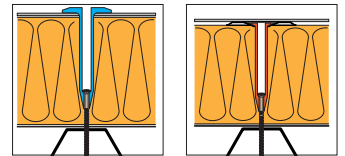

Substrate material quality: S235–S320GD
 Substrate material thickness: min. 0.6 mm
 max. 2×1.0 mm
 Setting depth: min. 20 mm

Application 2

Stainless steel fastener for waterproof membrane and insulation securement on timber and timber-based boards. For applications with increased requirements, such as high relative humidity, chemical aggressive atmospheres or conditions (e.g. coastal environments). For refurbishments with unknown condition of the existing build-up or build-up with abrasive layers that may damage the corrosion protection. If extended design life and/or warranty is required.

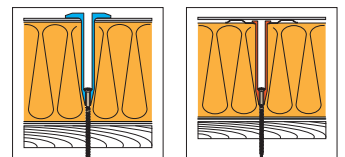

Substrate material thickness: min. 18 mm
 Setting depth: min. 30 mm

Product Information

Material: Austenitic stainless steel, European standard 1.4401, grade A4, AISI 316
 Drill tip and thread inlet, length 13 mm:
 Case hardened carbon steel, galvanised

Approvals/Assessments



ETA-08/0262

Declaration of Performance (DoP)

Features and Benefits

- Stainless steel quality A4, 1.4401, AISI 316
 - Fast and easy installation due to optimised drill tip
 - High pull-out values with asymmetric fastener thread
 - Environment friendly, free of Chromium VI
-









Product Range

Product Code	L_{mm}	TL_{mm}	PU	Material No.
BS-S-4,8×60	60	55	250	1341595
BS-S-4,8×80	80	75	250	1341596
BS-S-4,8×100	100	75	250	1341587
BS-S-4,8×120	120	75	250	1341588
BS-S-4,8×140	140	75	250	1341589
BS-S-4,8×160	160	75	250	1341591
BS-S-4,8×180	180	75	250	1341593
BS-S-4,8×200	200	75	250	1341594

Products to combine with

Product Code	Description	
FI-P-6,8	Stress plates for PVC, TPO and EPDM based waterproof membranes. For isoweld® field fastening application.	
RP48	Sleeve with 3 peaks for waterproof membrane and insulation securement in combination with fasteners BS-4,8, BS3-4,8 and BS-S-4,8. For seam fastening application.	
RP50	Sleeve for waterproof membrane and insulation securement in combination with fasteners BS-4,8, BS3-4,8 and BS-S-4,8. For seam fastening application. For use with setting tools IT260, IT260-B.	
RP75	Sleeve for insulation securement in combination with fasteners BS-4,8, BS3-4,8 and BS-S-4,8.	
R48	Sleeve with 3 peaks for waterproof membrane and insulation securement. For seam fastening application.	
R50	Sleeve for waterproof membrane and insulation securement. For seam fastening application.	
R75	Sleeve for insulation securement.	
FI-R-20	Sleeve for waterproof membrane and insulation securement. For isoweld® field fastening and seam fastening applications.	

Tools and Accessories

Product Code	Description	
IT260-B	Automated setting tool for the fast and economic installation of fasteners and sleeves. For pre-assembled combination of fasteners BS-4,8, BS3-4,8, BS-S-4,8 and sleeve RP50.	
ZA¼"-M6-300 ZA¼"-M6-750	Drive bar for installation of fastener and sleeve, length 300 mm and 750 mm	
ZA¼"-M6-EXT	Drive bar extension, length 100 mm	
T25-32-M6	Insert bit with T25 drive	
T25-32-M6-RING	Insert bit with T25 drive and ring to hold sleeves RP48, RP50, RP75 onto bit	
ZH-11-RING	Adapter to hold sleeves R48, R50, R75 onto drive bar	
ZH-12-RING	Adapter to hold sleeve FI-R-20 onto drive bar	
Bit holder ZA¼"	Bit holder for bits with HEX shaft	
T25-25-HEX¼"	Insert bit with T25 drive and HEX shaft	

Recommendations for Installation

Operating process	Recommendation	
Screwing in	<p>Power screwdriver</p> <ul style="list-style-type: none"> • 1000–3000 rpm • Min. 500 W <p>Battery tool</p> <ul style="list-style-type: none"> • 1000–3000 rpm • Min. 18 V • Battery with min. 2,5 Ah 	