

# TI-T25-6,3

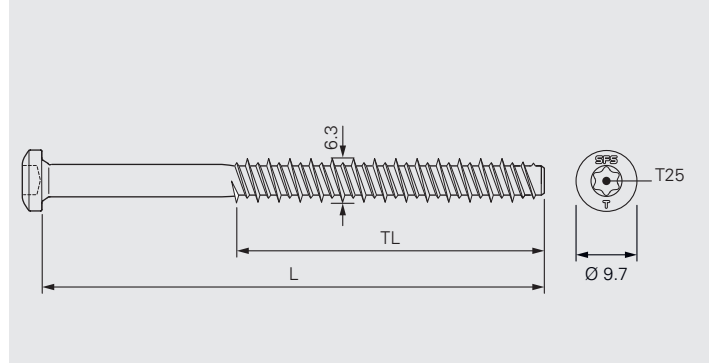

## Application

Carbon steel fastener for waterproof membrane and insulation securement on concrete deck.

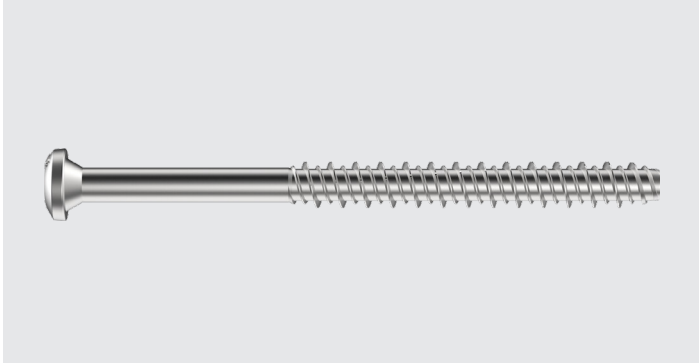
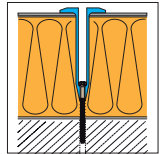

Substrate material quality:	min. C12/15
Substrate material thickness:	min. 40 mm
Pre-drill diameter:	5.0 mm, see "Tools and Accessories" for alternative drill diameters
Setting depth:	min. 20 mm
Depth of pilot hole:	min. 15 mm deeper than setting depth

## Product Information

Material:	Case hardened carbon steel
Corrosion protection:	Durocoat® Resistance 15 cycles Kesternich test according to <ul style="list-style-type: none"> <li>• EAD 030351-00-0402, A2.4</li> <li>• FM Approval Standard 4470</li> </ul>

## Approvals/Assessments



Declaration of Performance (DoP)





### Features and Benefits

- Fast and easy installation, pre-drill and screw
- Plug free installation
- Only 20 mm setting depth required
- Removable
- High quality corrosion protection, environment friendly, free of Chromium VI











### Product Range

Product Code	L <sub>mm</sub>	TL <sub>mm</sub>	PU	Material No.
TI-T25-6,3×30	30	27	500	1237863
TI-T25-6,3×50	50	47	500	1237865
TI-T25-6,3×60	60	50	250	1237869
TI-T25-6,3×70	70	50	250	1237870
TI-T25-6,3×80	80	50	250	1237871
TI-T25-6,3×90	90	50	250	1237872
TI-T25-6,3×100	100	50	250	1237873
TI-T25-6,3×120	120	50	250	1237874
TI-T25-6,3×140	140	50	250	1237875
TI-T25-6,3×160	160	50	250	1237876

## Products to combine with

Product Code	Description	
FI-P-6,8	Stress plates for PVC, TPO and EPDM based waterproof membranes. For isoweld® field fastening application.	
R48	Sleeve with 3 peaks for waterproof membrane and insulation securement. For seam fastening application.	
R50	Sleeve for waterproof membrane and insulation securement. For seam fastening application.	
R75	Sleeve for insulation securement.	
FI-R-20	Sleeve for waterproof membrane and insulation securement. For isoweld® field fastening and seam fastening applications.	

## Tools and Accessories

Product Code	Description	
SDS-5,0xL/L-SP SDS-4,8xL/L-SP* SDS-5,2xL/L-SP*	SDS drill bit	
ZVK-5,0xLxL ZVK-4,8xLxL* ZVK-5,2xLxL*	Conus drill bit for combination with ZAK drill extension	
ZVK-5,0xLxL-STOP ZVK-4,8xLxL-STOP* ZVK-5,2xLxL-STOP*	Conus drill bit with stop function for combination with ZAK drill extension	
ZAK-500 ZAK-750 ZAK1000	Drill extension for ZVK conus drill bits, length 500, 750 and 1000 mm	
ZA¼"-M6-300 ZA¼"-M6-750	Drive bar for installation of fastener and sleeve, length 300 mm and 750 mm	
ZA¼"-M6-EXT	Drive bar extension, length 100 mm	
T25-32-M6	Insert bit with T25 drive	
ZH-11-RING	Adapter to hold sleeves R48, R50, R75 onto drive bar	
ZH-12-RING	Adapter to hold sleeve FI-R-20 onto drive bar	
Bit holder ZA¼"	Bit holder for bits with HEX shaft	
T25-25-HEX¼"	Insert bit with T25 drive and HEX shaft	

\* Alternative drill diameter depending on local conditions. The optimum drill diameter can be determined via on-site pull-out tests.

## Recommendations for Installation

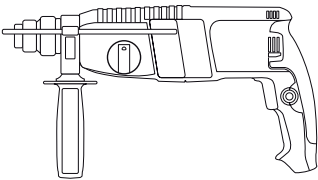
Operating process	Recommendation	
Pre-drilling	Hammer drill with weight class 2–3 kg, impact energy $\leq 2,5$ J	
Screwing in	Power screwdriver <ul style="list-style-type: none"> <li>• 300–700 rpm</li> <li>• Min. 500 W</li> </ul> Battery tool <ul style="list-style-type: none"> <li>• 300–700 rpm</li> <li>• Min. 18 V</li> <li>• Battery with min. 2,5 Ah</li> </ul> Do not use a percussion tool	